

RELEASE HISTORY

a	DRAWING/DESIGN CREATED Rev.0	10.09.2017 KN
b	DRAWING REDRAWN Rev.1	05.05.2021 RVS

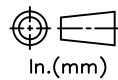

In.(mm)

PART# 2355550-7001

DRAWING NUMBER 3CY2-805-024

TITLE PIN TYPE INSULATOR

REF. ANSI TECHNICAL REFERENCE # 55-5

TECHNICAL CHARACTERISTICS

MECHANICAL RATINGS

CANTILEVER STRENGTH, lbs (kN) 3000 (13.34)

ELECTRICAL RATINGS

LOW FREQUENCY DRY FLASHOVER VOLTAGE, kV 80

LOW FREQUENCY WET FLASHOVER VOLTAGE, kV 45

CRITICAL IMPULSE FLASHOVER VOLTAGE, POSITIVE, kV 130

CRITICAL IMPULSE FLASHOVER VOLTAGE, NEGATIVE, kV 150

LOW FREQUENCY PUNCTURE VOLTAGE, kV 115

RADIO INFLUENCE VOLTAGE RATINGS

LOW FREQUENCY TEST VOLTAGE, kV 15

MAX. RIV AT 1000 kHz, μ V 100

PHYSICAL CHARACTERISTICS

LEAKAGE DISTANCE, in (mm) 12 (305)

DRY-ARCING DISTANCE, in (mm) 6.25 (159)

UNIT HEIGHT, in (mm) 4.875 (124)

UNIT DIAMETER, in (mm) 7 (178)

NET WEIGHT, lbs (kg) 6.6 (3)

GLAZE COLOR Light Gray

APPLICABLE STANDARD : ANSI C29.5

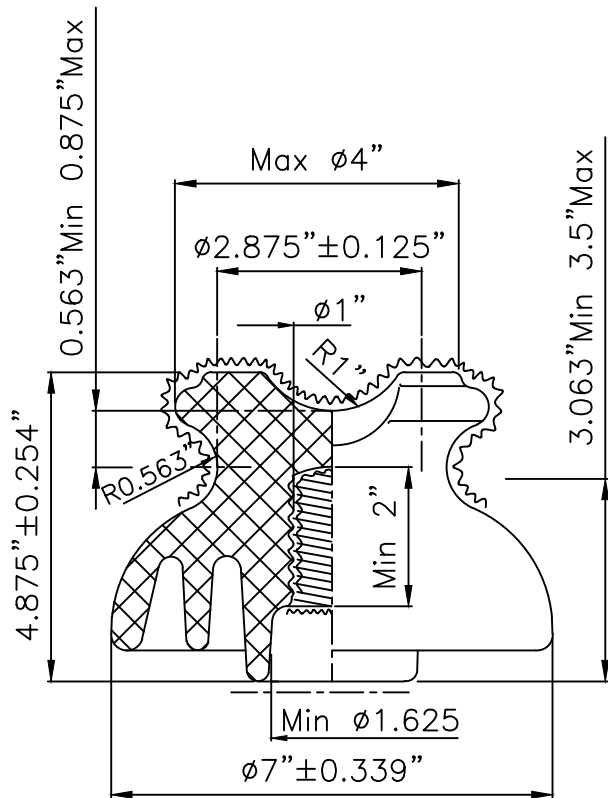

Note Light Grey glazed except surfaces marked-----left unglazed. Semi-conductive glaze applied on surfaces marked thus ~~~~~

REF.3CY2-805-024	DWG.TYPE SALES	DWN. RVS	APP.
------------------	----------------	----------	------