

RELEASE HISTORY

a	DRAWING/DESIGN CREATED Rev.0	08.09.2017 KN
b	DRAWING REDRAWN Rev.1	07.05.2021 RVS

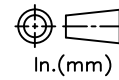
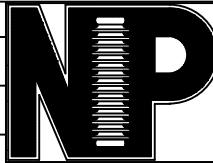

PART# 2355570-7001

DRAWING NUMBER 3CY2-805-050

TITLE PIN TYPE INSULATOR

REF. ANSI TECHNICAL REFERENCE # 55-7

TECHNICAL CHARACTERISTICS

MECHANICAL RATINGS

CANTILEVER STRENGTH, lbs (kN) 3000 (13.34)

ELECTRICAL RATINGS

LOW FREQUENCY DRY FLASHOVER VOLTAGE, kV 100

LOW FREQUENCY WET FLASHOVER VOLTAGE, kV 50

CRITICAL IMPULSE FLASHOVER VOLTAGE, POSITIVE, kV 150

CRITICAL IMPULSE FLASHOVER VOLTAGE, NEGATIVE, kV 170

LOW FREQUENCY PUNCTURE VOLTAGE, kV 135

RADIO INFLUENCE VOLTAGE RATINGS

LOW FREQUENCY TEST VOLTAGE, kV 22

MAX. RIV AT 1000 kHz, μ V 100

PHYSICAL CHARACTERISTICS

LEAKAGE DISTANCE, in (mm) 15 (381)

DRY-ARCING DISTANCE, in (mm) 8 (203)

UNIT HEIGHT, in (mm) 5.5 (140)

UNIT DIAMETER, in (mm) 8.375 (213)

NET WEIGHT, lbs (kg) 10.5 (4.75)

GLAZE COLOR Light Gray

APPLICABLE STANDARD : ANSI C29.5

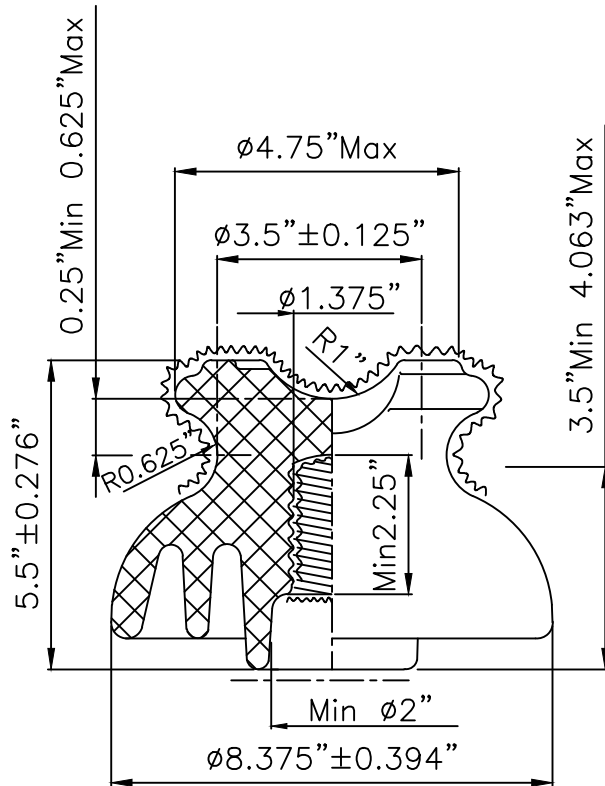

Note Light Grey glazed except surfaces marked-----left unglazed. Semi-conductive glaze applied on surfaces marked thus ~~~~~

REF.3CY2-805-050	DWG.TYPE SALES	DWN. RVS	APP.
------------------	----------------	----------	------