

RELEASE HISTORY

a	DRAWING/DESIGN CREATED Rev.0	31.05.2009 KN
b	DRAWING REDRAWN Rev.1	08.05.2021 RVS

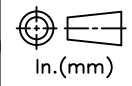

PART# 2365650-7001
DRAWING NUMBER 3CY2-805-055

TITLE PIN TYPE INSULATOR

REF. ANSI TECHNICAL REFERENCE # 56-5

TECHNICAL CHARACTERISTICS

MECHANICAL RATINGS

CANTILEVER STRENGTH, lbs (kN) 3000 (13.34)

ELECTRICAL RATINGS

LOW FREQUENCY DRY FLASHOVER VOLTAGE, kV 175

LOW FREQUENCY WET FLASHOVER VOLTAGE, kV 125

CRITICAL IMPULSE FLASHOVER VOLTAGE, POSITIVE, kV 270

CRITICAL IMPULSE FLASHOVER VOLTAGE, NEGATIVE, kV 340

LOW FREQUENCY PUNCTURE VOLTAGE, kV 225

RADIO INFLUENCE VOLTAGE RATINGS

LOW FREQUENCY TEST VOLTAGE, kV 44

MAX. RIV AT 1000 kHz, μ V 200

PHYSICAL CHARACTERISTICS

LEAKAGE DISTANCE, in (mm) 34 (864)

DRY-ARCING DISTANCE, in (mm) 14 (356)

UNIT HEIGHT, in (mm) 12.5 (318)

UNIT DIAMETER, in (mm) 13.5 (343)

NET WEIGHT, lbs (kg) 39.7 (18)

GLAZE COLOR Light Gray

APPLICABLE STANDARD : ANSI C29.6

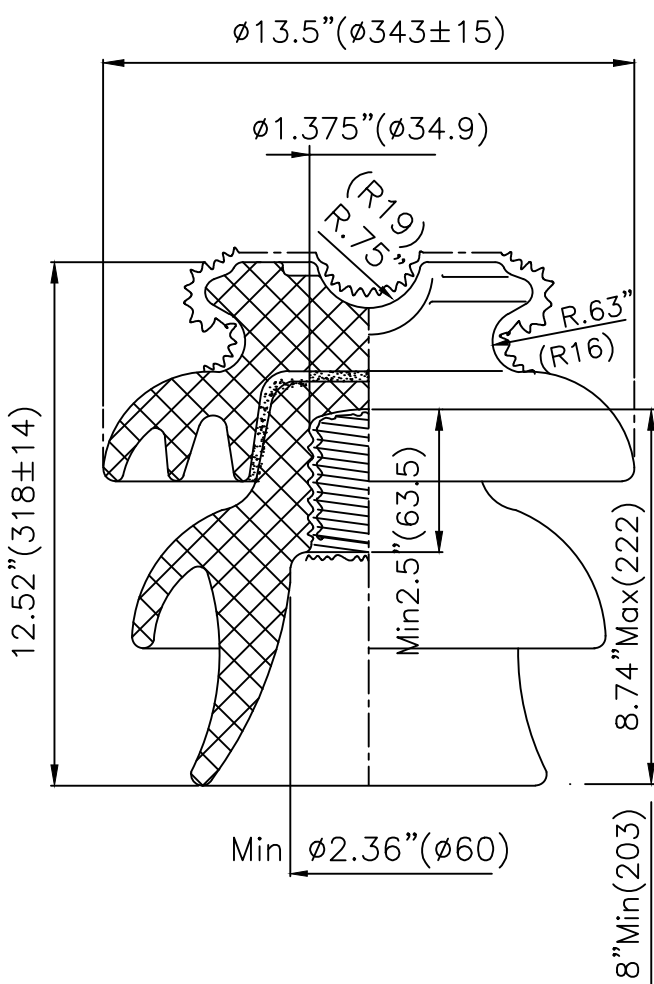

Note Light Grey glazed except surfaces marked-----left unglazed. Semi-conductive glaze applied on surfaces marked thus ~~~~~

REF.3CY2-805-055	DWG.TYPE SALES	DWN. RVS	APP.
------------------	----------------	----------	------