

RELEASE HISTORY

| | | |
|---|------------------------------|----------------|
| a | DRAWING/DESIGN CREATED Rev.0 | 16.04.2013 SNR |
| b | DRAWING REDRAWN Rev.1 | 13.04.2021 RVS |

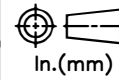

PART# 43970-7001

DRAWING NUMBER 3CY2.807.117

TITLE VERTICAL CLAMPTOP LINE POST INSULATOR

REF. ANSI TECHNICAL REFERENCE # 57-15

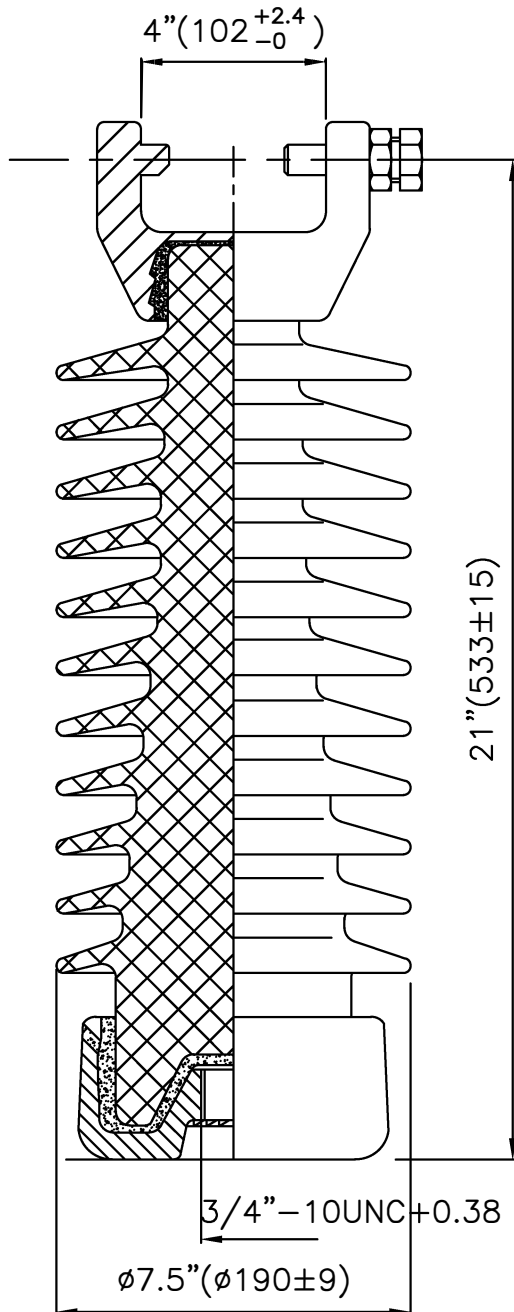

TECHNICAL CHARACTERISTICS

MECHANICAL RATINGS

CANTILEVER STRENGTH, lbs (kN) 2800 (12.5)

ELECTRICAL RATINGS

CRITICAL IMPULSE FLASHOVER VOLTAGE, POSITIVE, kV 290

LOW FREQUENCY FLASHOVER VOLTAGE, DRY, kV 175

LOW FREQUENCY FLASHOVER VOLTAGE, WET, kV 150

RADIO INFLUENCE VOLTAGE RATINGS

LOW FREQUENCY TEST VOLTAGE, kV 44

MAX. RIV AT 1000 kHz, µV 200

PHYSICAL CHARACTERISTICS

MINIMUM LEAKAGE DISTANCE, in (mm) 45 (1143)

DRY ARCING DISTANCE, in (mm) 17.25 (438)

NET WEIGHT, lbs (kg) 45 (20.5)

GLAZE COLOR Light Gray

APPLICABLE STANDARD : ANSI : C29.7

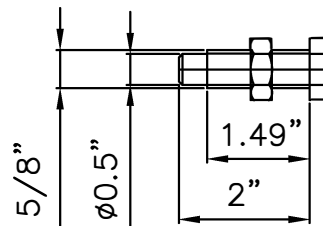

VISUAL AND DIMENSIONAL INSPECTION ACCORDING TO IEC 383

| | | | | | |
|----------|-----------|------|----------------|----------|------|
| MATERIAL | PORCELAIN | REF. | DWG.TYPE SALES | DWN. RVS | APP. |
|----------|-----------|------|----------------|----------|------|