

RELEASE HISTORY

a	DRAWING/DESIGN CREATED Rev.0	05.11.2013 SNR
b	DRAWING REDRAWN Rev.1	16.04.2021 RVS

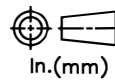

PART# 48663-7001

DRAWING NUMBER 3CY2.807.138

TITLE HORIZONTAL CLAMPTOP LINE POST INSULATOR-STUD MOUNT

REF. ANSI TECHNICAL REFERENCE # 57-23

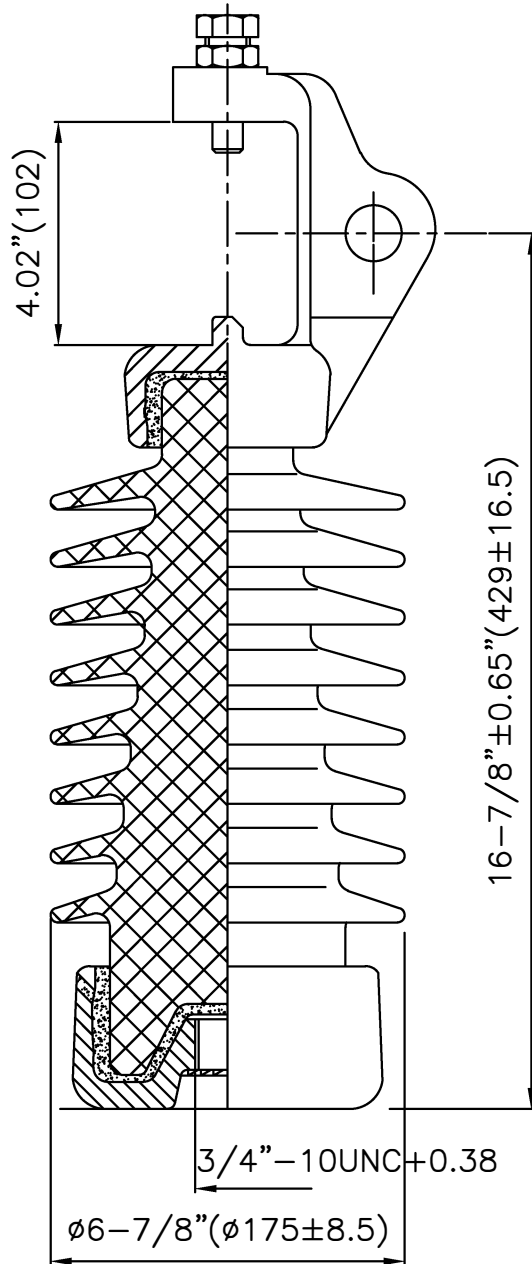

**TECHNICAL CHARACTERISTICS**

**MECHANICAL RATINGS**

CANTILEVER STRENGTH, lbs (kN) 2800 (12.5)

**ELECTRICAL RATINGS**

CRITICAL IMPULSE FLASHOVER VOLTAGE, POSITIVE, kV 210

LOW FREQUENCY FLASHOVER VOLTAGE, DRY, kV 125

LOW FREQUENCY FLASHOVER VOLTAGE, WET, kV 115

**RADIO INFLUENCE VOLTAGE RATINGS**

LOW FREQUENCY TEST VOLTAGE, kV 30

MAX. RIV AT 1000 kHz,  $\mu$ V 200

**PHYSICAL CHARACTERISTICS**

MINIMUM LEAKAGE DISTANCE, in (mm) 29 (737)

DRY ARCING DISTANCE, in (mm) 12.25 (311)

NET WEIGHT, lbs (kg) 29 (13.2)

GLAZE COLOR Light Gray

APPLICABLE STANDARD : ANSI : C29.7

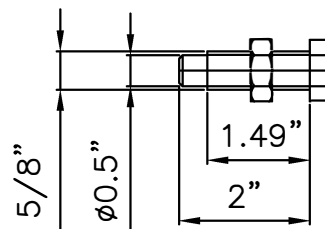

VISUAL AND DIMENSIONAL INSPECTION ACCORDING TO IEC 383

MATERIAL	PORCELAIN	REF.	DWG.TYPE SALES	DWN. RVS	APP.
----------	-----------	------	----------------	----------	------