

RELEASE HISTORY

| | | |
|---|------------------------------|----------------|
| a | DRAWING/DESIGN CREATED Rev.0 | 06.02.2021 SNR |
| b | DRAWING REDRAWN Rev.1 | 16.04.2021 RVS |

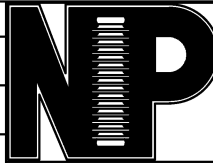

| | |
|--|-----------------------------|
| In.(mm) | PART# 48666-7001 |
| | DRAWING NUMBER 3CY2.807.274 |
| TITLE HORIZONTAL CLAMPTOP LINE POST INSULATOR-STUD MOUNT | |

REF. ANSI TECHNICAL REFERENCE # 57-24

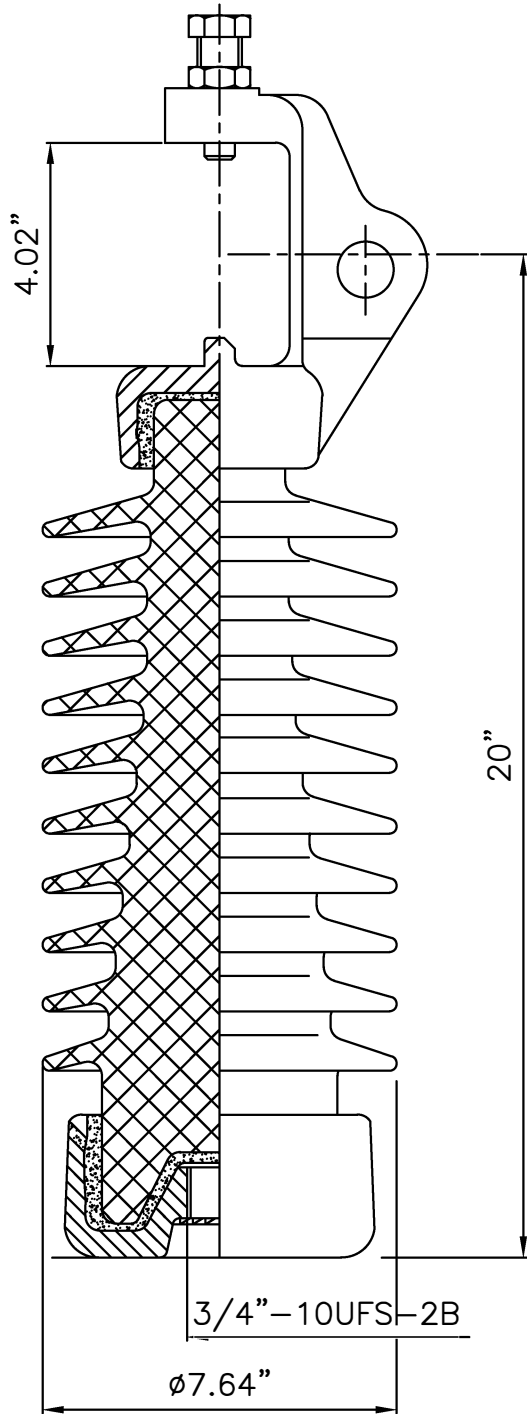

TECHNICAL CHARACTERISTICS

MECHANICAL RATINGS

CANTILEVER STRENGTH, lbs (kN) 2800 (12.5)

ELECTRICAL RATINGS

CRITICAL IMPULSE FLASHOVER VOLTAGE, POSITIVE, kV 275
 LOW FREQUENCY FLASHOVER VOLTAGE, DRY, kV 160
 LOW FREQUENCY FLASHOVER VOLTAGE, WET, kV 145

RADIO INFLUENCE VOLTAGE RATINGS

LOW FREQUENCY TEST VOLTAGE, kV 44
 MAX. RIV AT 1000 kHz, μV 200

PHYSICAL CHARACTERISTICS

MINIMUM LEAKAGE DISTANCE, in (mm) 42 (1067)
 DRY ARCING DISTANCE, in (mm) 15.98 (406)
 NET WEIGHT, lbs (kg) 37 (16.8)
 GLAZE COLOR Light Gray

APPLICABLE STANDARD : ANSI : C29.7

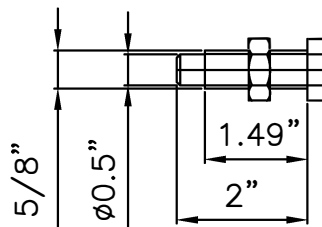

VISUAL AND DIMENSIONAL INSPECTION ACCORDING TO IEC 383

| | | | | | |
|----------|-----------|------|----------------|----------|------|
| MATERIAL | PORCELAIN | REF. | DWG.TYPE SALES | DWN. RVS | APP. |
|----------|-----------|------|----------------|----------|------|